

		Dry Methods			Wet Methods (tiles must be cleaned using dry methods before wet cleaning)							
		A1: Soft brush A2: Clean, dry, soft white cloth A3: Vacuum system (with brush)		H: Pencil erasers to remove fingerprints or pencil marks	B1: Moist cloth with no detergent C1: A moist cloth with mild detergent diluted in warm water		B2: Damp sponge with no detergent C2: Damp sponge with mild detergent diluted in warm water		D: Damp rough texture sponge; (using medium pressure)		G: Resistant to popular disinfectants (due to large number of types of disinfectants, always test a small area first)	
MINERAL SOLUTIONS	PRESTIGE, PRESTIGE dB, PRESTIGE hA+	✓	Daily	✓	✓	Weekly	✓	Weekly				
	OPLIA, OPLIA dB, OPLIA hA, OPLIA hA+, OPLIA hA dB	✓	Daily		✓	Monthly	✓	Weekly				
	OBSIDIAN	✓	Daily									
	SERENE hA	✓	Daily	✓	✓	Monthly	✓	Weekly				
	ARUBA, ARUBA dB, ARUBA MAX	✓	Daily				✓	Weekly				
	FISSION FT	✓	Daily	✓								
	ACOUSTA	✓	Daily	✓	✓	Weekly	✓	Weekly				
	CANOPY / BAFFLE / WALL ABSORBER	✓	Daily	✓	✓	Weekly	✓	Weekly				
	SONIFY	✓	Daily									
SPECIFIC SOLUTIONS	BIOBLOC ACOUSTIC	✓	Daily	✓	✓	Daily	✓	Daily	✓	Weekly	✓	Daily
	BIOBLOC PLAIN	✓	Daily	✓	✓	Monthly	✓	Weekly			✓	Weekly
	CLEANTECH	✓	Daily	✓	✓	Weekly	✓	Weekly			✓	Weekly
	HYGIENE	✓	Daily	✓	✓	Weekly	✓	Weekly			✓	Weekly
	HYDRABLOC	✓	Daily	✓	✓	Weekly	✓	Weekly			✓	Weekly
	TITAN	✓	Daily	✓	✓	Weekly	✓	Daily				
	AQUABLOC	✓	Daily	✓	✓	Weekly	✓	Daily				
	ARUBA hH	✓	Daily				✓	Weekly				
	MEZZGUARD	✓	Daily				✓	Weekly				
	VYNABOARD	✓	Daily	✓	✓	Weekly	✓	Daily				



Wipeable with a dry cloth / soft brush (A1 - A2 - A3)



Wipeable with a moist cloth (B1 - C1)



Washable with a sponge dampened in water containing mild soap or diluted detergent (B2 - C2)



Scrubable with water containing mild soap or diluted detergent (D)



Can be cleaned with disinfectants commonly used in healthcare premises (G)

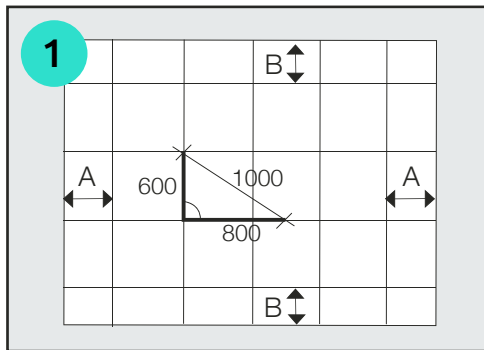

1. Planning grid layout

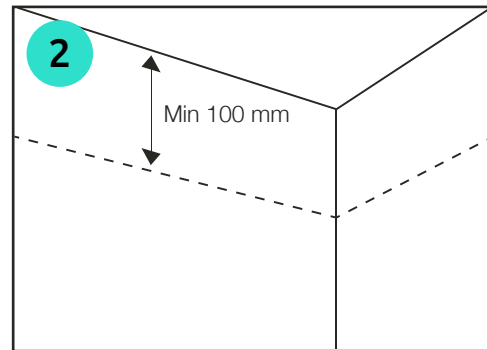

2. Mark the perimeter trim lines

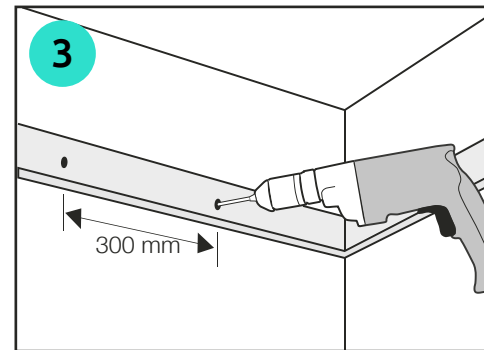

3. Installation of perimeter trims

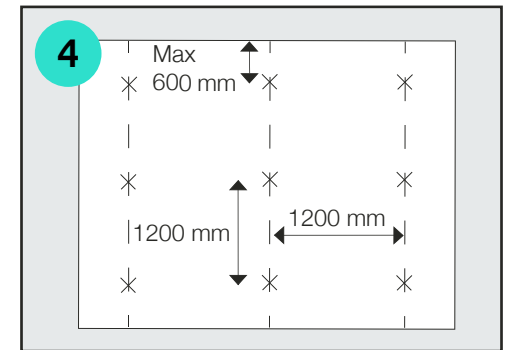

4. Mark hanger positions

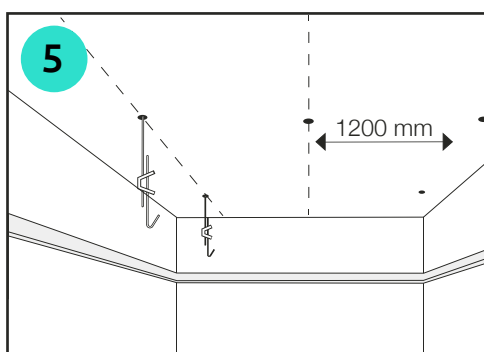

5. Installation of hangers

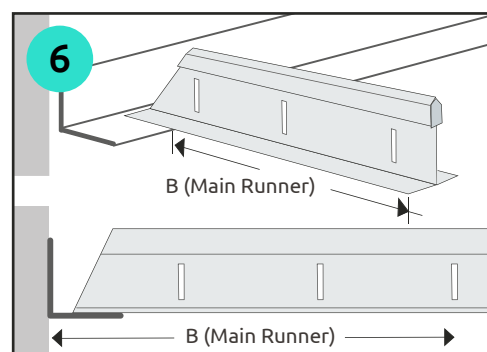

6. Positioning Main Runner slots

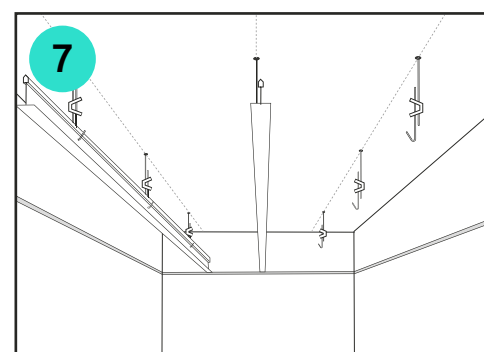

7. Installation of Main Runners

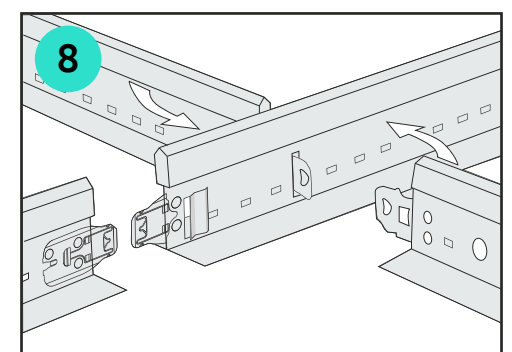

8. Cross Tees installation right to right

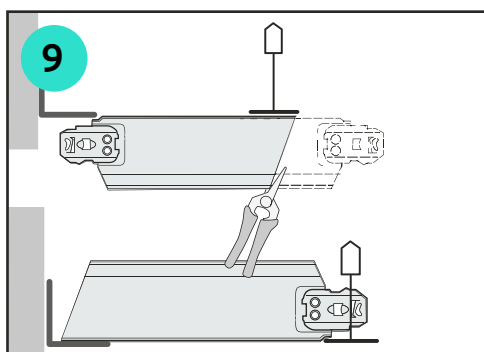

9. Cutting Cross Tees

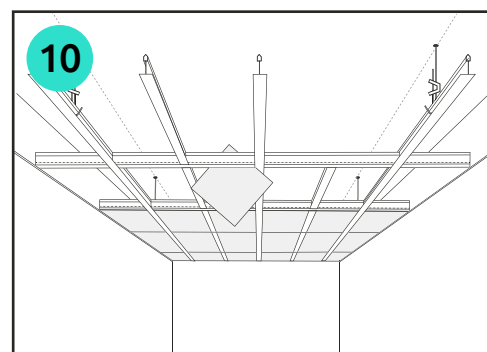

10. Installation of tiles

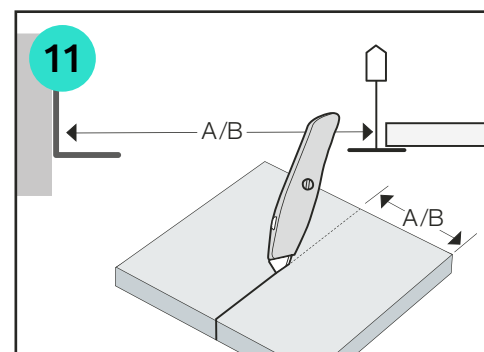

11. Measure and cut perimeter tiles

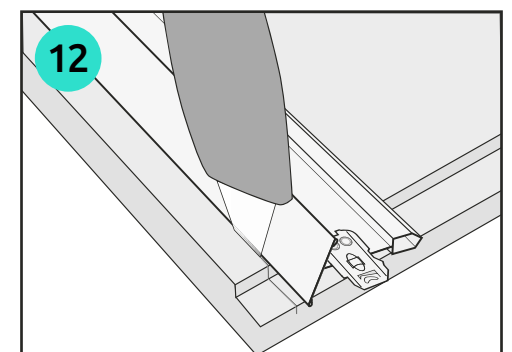

12. Re-regulating Tegular24 or Tegular15 tiles

Post Installation

Maintenance

- After the installation of a suspended ceiling system it is important to ensure that it is properly maintained and that any additional works are not detrimental to the performance of the ceiling installation. Maintenance operations must only be undertaken after the technical impact on the ceiling system has been completely evaluated. For example, hangers should not be removed, adapted or bent without fully understanding the consequences and taking any appropriate mitigating actions.
- Zentia suspension systems do not need any more maintenance than normal painted metal surfaces. However, if cleaning is required dust and superficial dirt can easily be removed with a soft brush or a vacuum cleaner with a brush attachment. For more stubborn marks a lightly dampened cloth or sponge can be used, although never use abrasive products.
- Zentia ceiling tiles should be maintained and cleaned in accordance with the Zentia Cleaning Matrix, which should be followed to ensure that the performance and appearance of the ceiling is maintained.
- Zentia ceiling tiles should first have any surface dust removed using a soft brush. Pencil marks, smudges etc may be removed with an ordinary eraser. Alternatively, a moist cloth or sponge dampened in water containing a mild soap or diluted detergent can be used. The sponge should contain as little water as possible and the ceiling must not be made wet. The process should be repeated again in a similar manner with a damp sponge but with clean water only to remove any residual soap or detergent. No abrasive cleaners should be used, and cleaning methods should be tested on a spare tile or hidden area where possible.
- Damaged tiles can be replaced with new tiles or tiles held in stock for this specific purpose. Where there is a colour variation between new and existing tiles, replacing all tiles in a particular area and using the re-usable tiles for refurbishment elsewhere is recommended.
- Over painting ceiling tiles and suspension grid will impact on the fire and/or acoustic performance of the system, and will invalidate the Zentia warranty for the product.