



Perimeter detailing

Standard perimeter trims for classic perimeter solutions with mineral ceilings.

Key Features

- // Comprehensive range including angle trims, shadowlines trims, channels and F-upstand trims
- // All ceilings – perimeters

Physical Data

- // Material: steel
- // Surface finish: baked polyester paint
- // Colour: Global White

Perimeter Detailing

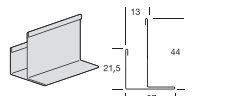
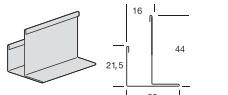
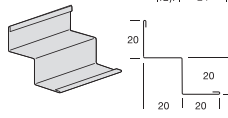
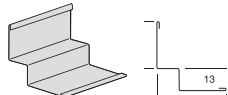
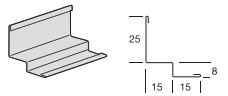
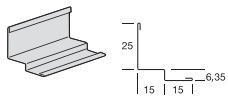
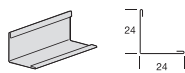
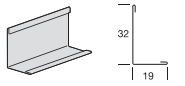
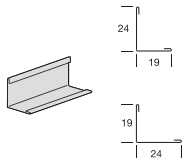

| Item No. | Description | Dimensions (mm) | | Colours | | | |
|----------|--|-----------------|-------|--------------|-----------------|-------|-----------------------|
| | | Length | Depth | Global White | Silver RAL 9006 | Black | Additional 34 colours |
| T 1924 H | Gridline perimeter angle, painted | 3000 | 0.54 | • | | | • |
| T 1924 L | Gridline perimeter angle, corrosive resistant | 3050 | 0.55 | • | | | |
| T 2419 H | Gridline perimeter angle, painted | 3000 | 0.45 | | • | • | |
| T 1932 H | Gridline perimeter angle, painted | 3000 | 0.45 | • | | | • |
| T 1919 H | Gridline perimeter angle, painted | 3000 | 0.45 | • | | | |
| T 2401 H | Perimeter angle, painted heavy duty | 3050 | 0.70 | • | | | |
| T 2424 H | Gridline perimeter angle, painted | 3050 | 0.45 | • | | | |
| T 1506 H | Gridline Shadowline, painted | 3050 | 0.45 | • | | | |
| T 1508 H | Gridline Shadowline, painted | 3050 | 0.45 | • | | • | |
| 7875 G | Shadowline, painted, for Prestige, Integra | 3050 | 0.45 | • | | | |
| T 2020 H | Shadowline, painted | 3000 | 0.65 | • | | | |
| 7856 H | Gridline F upstand trim, painted for 16mm thick panels | 3050 | 0.45 | • | | | |
| 7852 H | Gridline F upstand trim, painted for 13mm thick panels | 3050 | 0.45 | • | | | |

Flexible Perimeter Trim

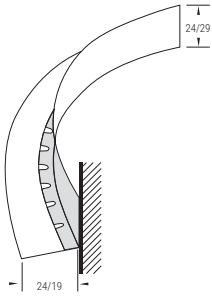

| Item No. | Dimensions (mm) | | Standard colours |
|----------|-----------------|-----------|------------------|
| | Length | Thickness | Global White |
| FT 2424 | 3050 | 0.45 | • |
| FT 1929 | 3050 | 0.45 | • |

Accessories

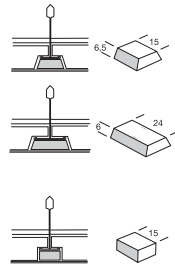

| Item No. | Description | Dimensions (mm) |
|----------|--|-----------------|
| | | Length |
| A 156 G | Perimeter fill-in clip for 15 mm grid – Tegular15 (75° angled) | - |
| A 246 G | Perimeter fill-in clip for 24 mm grid – Tegular24 (75° angled) | - |
| A 157 | Perimeter fill-in clip for 15 mm grid – Tegular15 (90° angled) | - |

Suspension & Hold Down Clips

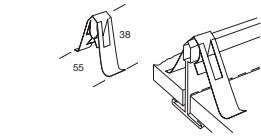

A 7890 G

Universal hold down clip

-

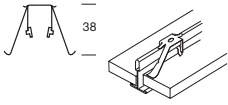

A 819 G

Locking hold down clip, 6-30mm tiles (Peakform & Square bulb)

64



A 7902

Hold down clip for 18-25mm soft fibre panels

40

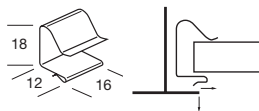

A 425 H

Board Access clip for standard 24mm T-bar

-

A 426 H

Board Access clip for Clean Room 24 T-bar (Global White)

-

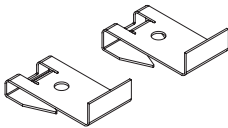

440 B

Prestige Integra (previously Ultima+ Vector) border clip

-



441 B

Optima Vector border clip

-



442 B

Integra (previously Vector) Seismic clip

-

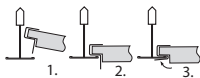

A 7930 H

Last tile clip Tegula24 (Global White)

40

A 7931 H

Last tile clip Tegular15 (Global White)

40

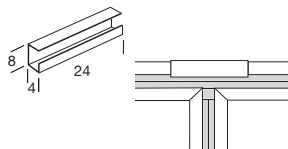

MCC4 G

Mitre closure clip for 6mm Silhouette (Global White)

-

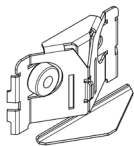

BPATTNBHA

Triangular Tile Nodal Bracket Double

-

If you would like to order a sample or have any queries about this product please contact our Technical Sales Team on **0800 371 849** or email info@zentia.com

TDS 123.2.04.24